

# GLASGOW OFFICE

Scotland House,  
165-169 Scotland Street,  
Glasgow,  
G5 8PL

☎ +44 (0) 141 307 8400  
☎ +44 (0) 141 307 8401

e-mail: [mail@murgitroyd.com](mailto:mail@murgitroyd.com)  
website: [www.murgitroyd.com](http://www.murgitroyd.com)



MURGITROYD  
&  COMPANY  
European Patent and Trade Mark Attorneys

# GLASGOW OFFICE

## How to find us:

### BY AIR

The nearest international airport to the Glasgow Office is Glasgow Airport. From Glasgow Airport visitors, if travelling by road, should travel towards the city centre of Glasgow on the M8 motorway leaving the motorway at junction 21 and then following the directions on the map shown. Car hire is available at Glasgow Airport. Alternatively taxis are available outside the main terminal building. Should visitors arriving by air make their way to the Glasgow Office by public transport, shuttle buses to the city centre of Glasgow are again available outside the main terminal building. From the city centre visitors should follow the directions given below for visitors travelling by train.

### BY TRAIN

Glasgow has two mainline railway stations: Central Station (serving trains from the west and south) and Queen Street Station (serving trains from the north and east). A shuttle bus carries passengers between the two stations that are less than a mile apart. Visitors arriving by train should take the subway from the subway station at Queen Street Station (Buchanan St) to Shields Road subway station. When exiting Shields Road subway station onto Scotland Street, the Glasgow Office is about two hundred metres down the street to the left.

### BY CAR

Visitors coming to the Glasgow Office by car should enter Glasgow via the M8 motorway from either the east or west.

From Glasgow airport & the west follow the M8 eastbound signposted city centre, until junction 21 (Shields Road park and ride/Tradeston/Kinning Park). At the roundabout take the second exit, and keep left past Shields Road subway.

From Edinburgh & the East follow the M8 Westbound signposted "Glasgow/Greenock". When you come on to the Kingston Bridge make your way over to the left hand lanes to take Junction 20 signposted "East Kilbride / City Centre South". Once through the traffic signals take your first right onto Wallace St. Take a right at the lights onto Tradeston St and move to the left hand lane. Take a right at the lights onto Cook street. Take a left at the lights onto West Street, follow the road round onto Scotland Street.

From Paisley Road take Seaward St to roundabout under the M8 motorway, turn left onto Scotland St, at Shields Rd subway station.

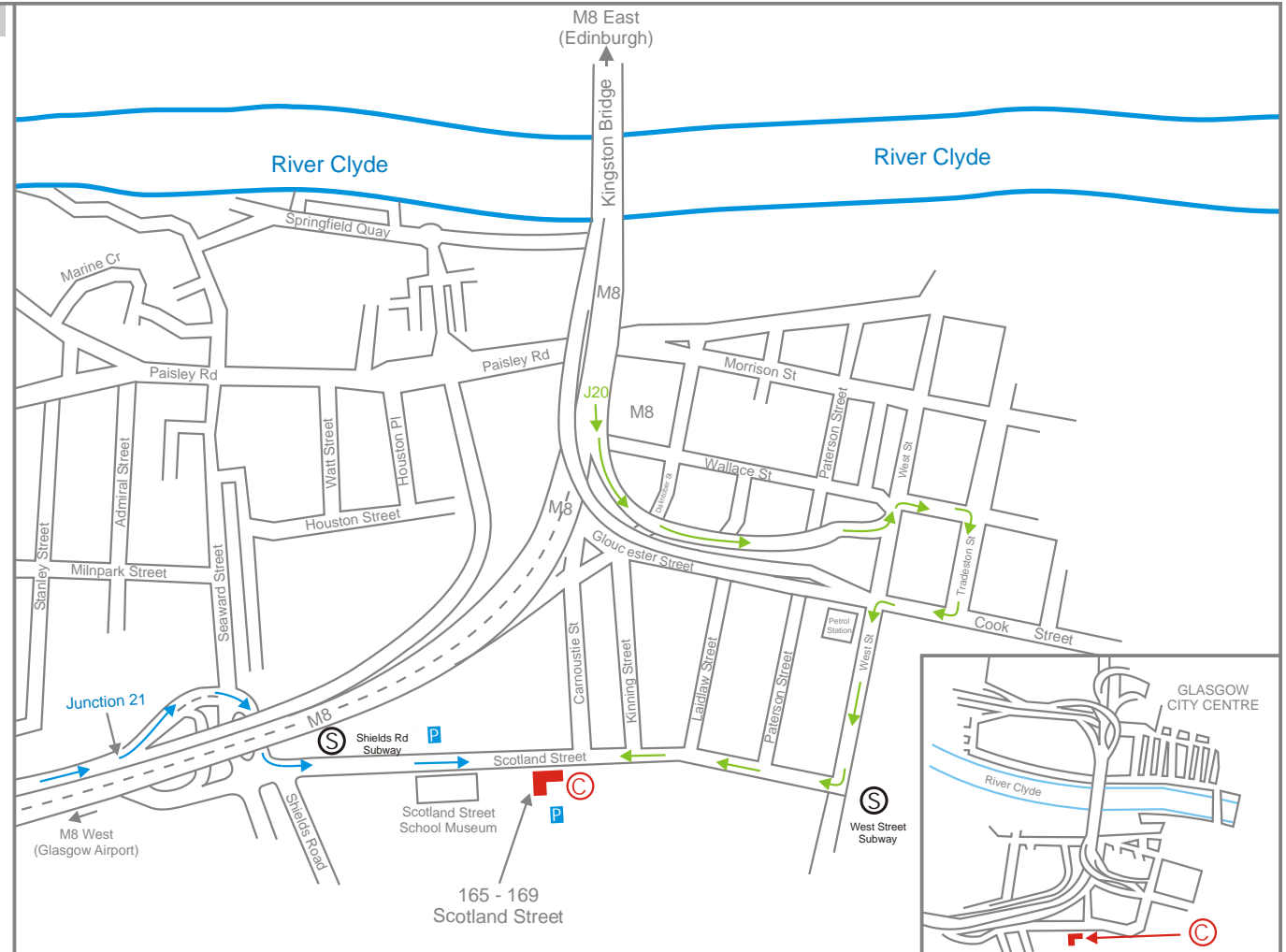

Scotland House  
165 - 169 Scotland Street  
Glasgow  
G5 8PL

Tel: +44 (0) 141 307 8400  
Fax: +44 (0) 141 307 8401

e-mail: [mail@murgitroyd.com](mailto:mail@murgitroyd.com)  
website: [www.murgitroyd.com](http://www.murgitroyd.com)

MURGITROYD  
& COMPANY  
European Patent and Trade Mark Attorneys